

# SEOM<sup>+</sup>

## SURVEILLANCE SYSTEM

AI-assisted observation and surveillance system with high-resolution electro-optical sensors for precise detection, recognition, and identification of long-range targets.



SEOM is an electro-optical system, equipped with high-resolution sensors inside: visible camera, thermal camera and laser rangefinder. AI-assisted image processing facilitates the detection, recognition, and identification of targets at long distances. Sensors of different types, such as LWIR and MWIR, can be installed for easy adaptation to the needs of each application.

SEOM can be adapted to any positioning platform. When mounted on our MSP systems (pan & tilt), it allows for interconnection with weapon stations for synchronized control. Its gyro-stabilization capability makes it suitable for artillery systems requiring long-range targeting, as well as for advanced observation systems.

A wide variety of functionalities, like sensor parameters, image from the cameras, zoom and distance-to-target information can be controlled from a remote command panel.

### KEY FEATURES

- Integrated Tracking
- Optional Control Software
- Long-Range Continuous Zoom
- Thermal Versions: LWIR / MWIR
- Video Output: (HD-SDI / Ethernet)
- Optional Gyro-Stabilization
- MIL-STD-1275E (Vehicles)
- MIL-STD-810G (Environment)
- MIL-STD-461E (EMC)
- Optional Control panel

### APPLICATIONS

- Border and Coast Surveillance
- Target Designation
- Drone Defense Systems
- Weapon stations

# SEOM SURVEILLANCE SYSTEM

## SEOM: SENSORS

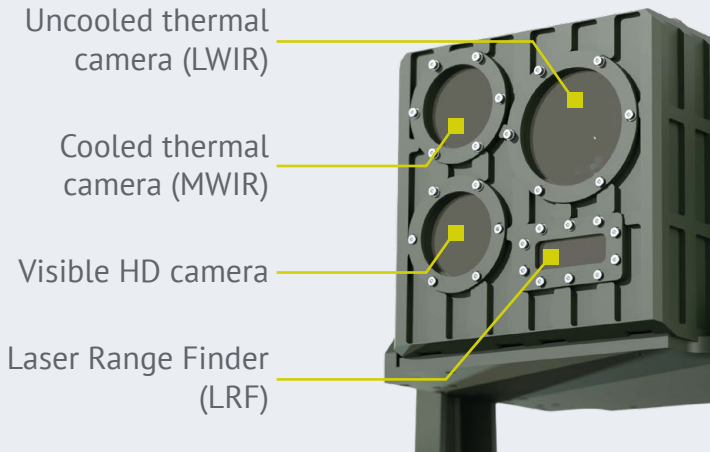

## SEOM+MSP DIMENSIONS

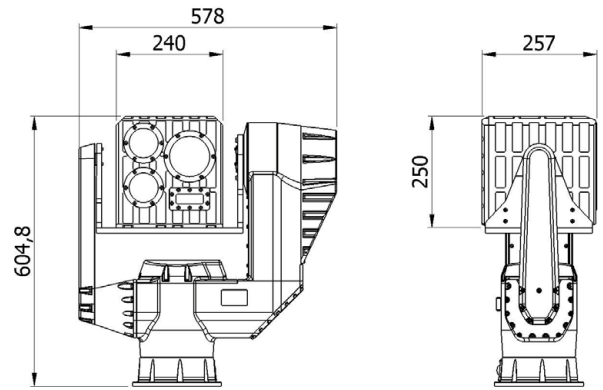

## JOYSTICK (OPTIONAL)



## TYPICAL DRI VALUES

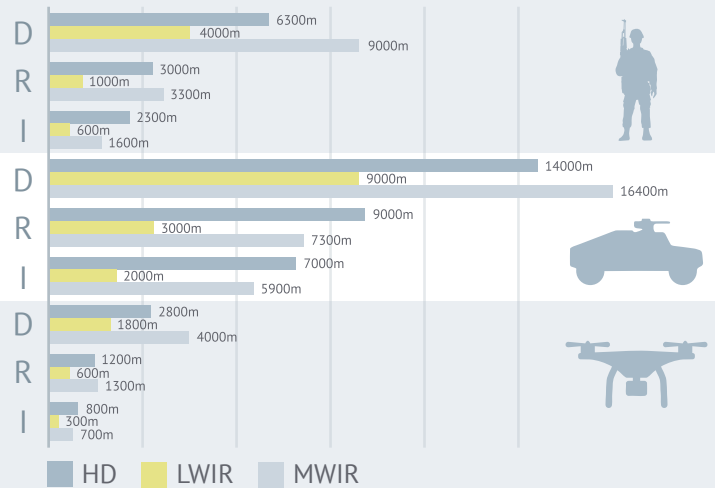

## SEOM

Dimensions (mm)	578 × 257 × 605
Mass	46Kg
Gyro-stabilization	2 axis (optional)
Working temperature range	from -25°C to +60°C
IP protection grade	IP65
Certifications MIL-STD	1275E / 810G / 461E
Input voltage range	from 16Vdc to 40Vdc
Power consumption	350W
Connectivity	2xHD-SDI + 1xEthernet + 1xRS422

## Laser Range Finder (LRF)

Ranging capability	32Km
Precision	0.01 - 0.5m
Beam divergence	0.6mrad
Eye safe / Laser Class	Laser Class 1

	Visible HD	LWIR	MWIR
Resolution	1920 x 1080p	640 x 512 / 12um	640 x 512 / 15um
Frequency	60Hz	50Hz	50Hz
NETD	-	40mK	-
Cooling method	-	-	Stirling
Zoom	30x (continuous)	4x (continuous)	14x (continuous)
Wide FOV / Narrow FOV	64° (H) / 2.3° (H)	17.5° (H) / 4.4° (H)	26.5° (H) / 2° (H)
DRI (NATO target 2.3 x 2.3m)	14Km / 9Km / 7Km	9Km / 3Km / 2Km	16.4Km / 7.3Km / 5.9Km
DRI (Person)	6.3Km / 3Km / 2.3Km	4Km / 1Km / 0.6Km	9.0Km / 3.3Km / 1.6Km
DRI (UAV)	2.8Km / 1.2Km / 0.8Km	1.8Km / 0.6Km / 0.3Km	4.0Km / 1.3Km / 0.7Km

TEL +34 671 90 58 56

WEB [www.mecanusinnovacion.com](http://www.mecanusinnovacion.com)

MAIL [contacto@mecanusinnovacion.com](mailto:contacto@mecanusinnovacion.com)

Mecanus Innovacion SL

CEEI ARAGÓN - C/ María de Luna 11, Nave 11

50018 Zaragoza (Spain)